

- GENERAL NOTES** UNLESS OTHERWISE SPECIFIED
- 1 DIMENSIONS HAVE PREFERENCE OVER SCALE
 - 2 CONTRACTOR SHALL VERIFY ALL DIMENSIONS & CONDITIONS @ EACH JOB SITE
 - 3 ALL PLACES OF CONSTRUCTION SHALL COMPLY W/ THE CURRENT EDITION OF THE USC AND/OR STATE & LOCAL CODES
 - 4 PATIO COVER CANOPY SUPPORTING MEMBERS GUTTER AND DOWNPOUT SHALL BE ALUMINUM W/ BAKED ENAMEL FINISH
 - 5 CONTRACTOR SHALL SECURE & PAY FOR ALL PERMITS REQUIRED BY PCM AND THE ORANGE COUNTY DEPT OF BUILDING AND SAFETY
 - 6 UPON COMPLETION CONTRACTOR SHALL REMOVE ALL DEBRIS AND EXCESS MATERIAL AND LEAVE ALL AREAS OF WORK BROOM CLEAN
 - 7 CONNECTION TO EXISTING CONSTRUCTION BASED UPON DESIGN LOADS AS FOLLOWS LL 10 PSF DL 5 PSF (70 401)

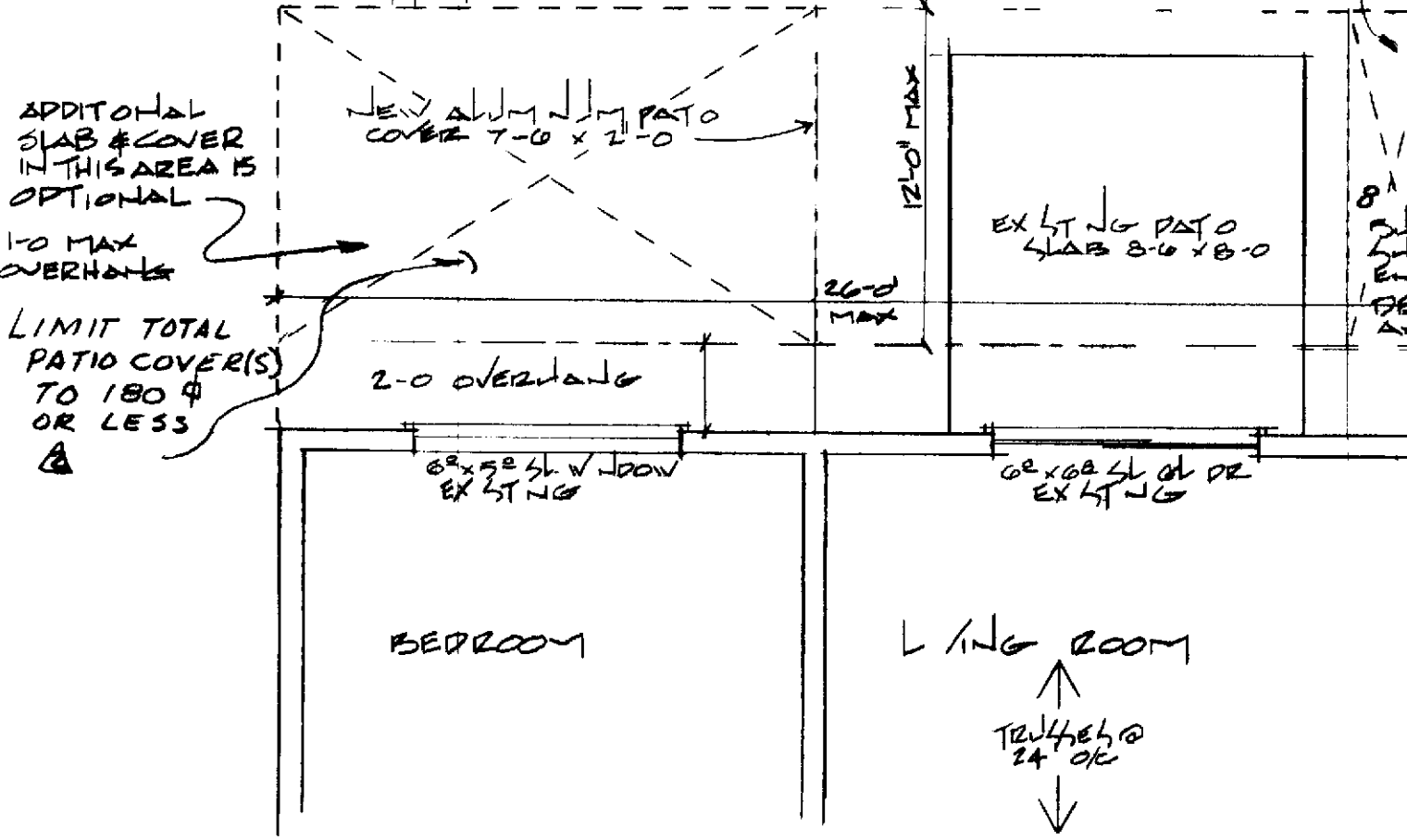

ADDITIONAL SLAB & COVER IN THIS AREA OPTIONAL

1'-0" MAX OVERHANG

8" ALUMINUM FABRICATOR SHALL FURNISH BUILDING OFFICIAL WITH CALCULATIONS AND SHOP DRAWINGS SIGNED BY CIVIL OR STRUCTURAL ENGINEER LICENSED IN CALIFORNIA SUCH DESIGN SHALL INCLUDE BOTH VERTICAL LOADING AND LATERAL RESISTANCE

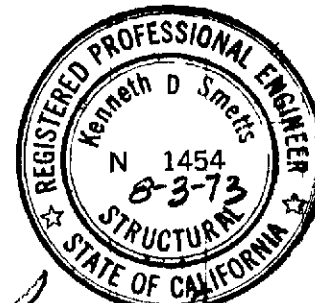

Kenneth D. Smith
 12-15-73 Increase size of cover

LA PRINCELA (PLAN 41) PATIO COVER ALUMINUM REAR	
LEISURE WORLD STANDARD PLAN NUMBER	
PROFESSIONAL COMMUNITY MEETING APPROVED	
PCM INC POB 2220	380-4616 LAGUNA HILLS
112	
REV 12-14-78 TBW	